

Floor Plans submitted to City Planning Department shall comply with the following specifications. Additional materials or information may be required according to each type of application. Application forms are available under the [Forms & Processes](#) section at www.planning.lacity.org and at the Public Counters, located at 201 N. Figueroa Street, 4th Floor, Los Angeles, CA 90012 (phone: 213-482-7077) and at 6262 Van Nuys Boulevard, Room 251, Van Nuys, CA 91401 (phone: 818-374-5050).

NOTE: An illegible or inadequate Floor Plan cannot be accepted. When reducing full-sized plans, font sizes and dimensions shall be made large enough so they can be read at the reduced size (see “Size and Number of Copies” in the Master Land Use Instructions). Include only information necessary to depict the project and its setting (do not include mechanical or structural drawings).

1. **Boundaries:**

Floor Plans shall include the entire building or premises subject to the approval.

2. **Technical Requirements:**

- a. Walls - Shown as double lines. Walls that will be demolished to be shown as dashed or shadowed lines.
- b. Scale - No less than 1/16” to equal 1’.
- c. North Arrow.
- d. Street Address of project.
- e. All dimensions of the premises.
- f. Area calculations in square feet for all notable areas.
- g. Locations of all seats, bars and tables for restaurants. Seats to be individually numbered.
- h. Total number of seats.
- i. Floor Plans must include any outdoor areas if they are to be used as part of the project.
- j. Label individual areas, features, rooms, uses and major items of equipment (e.g. living room, auditorium, entry, freezers, stoves, etc...)
- k. For CUB and CUE filings, include location of all alcohol storage and display areas.

Interior Floor Plan

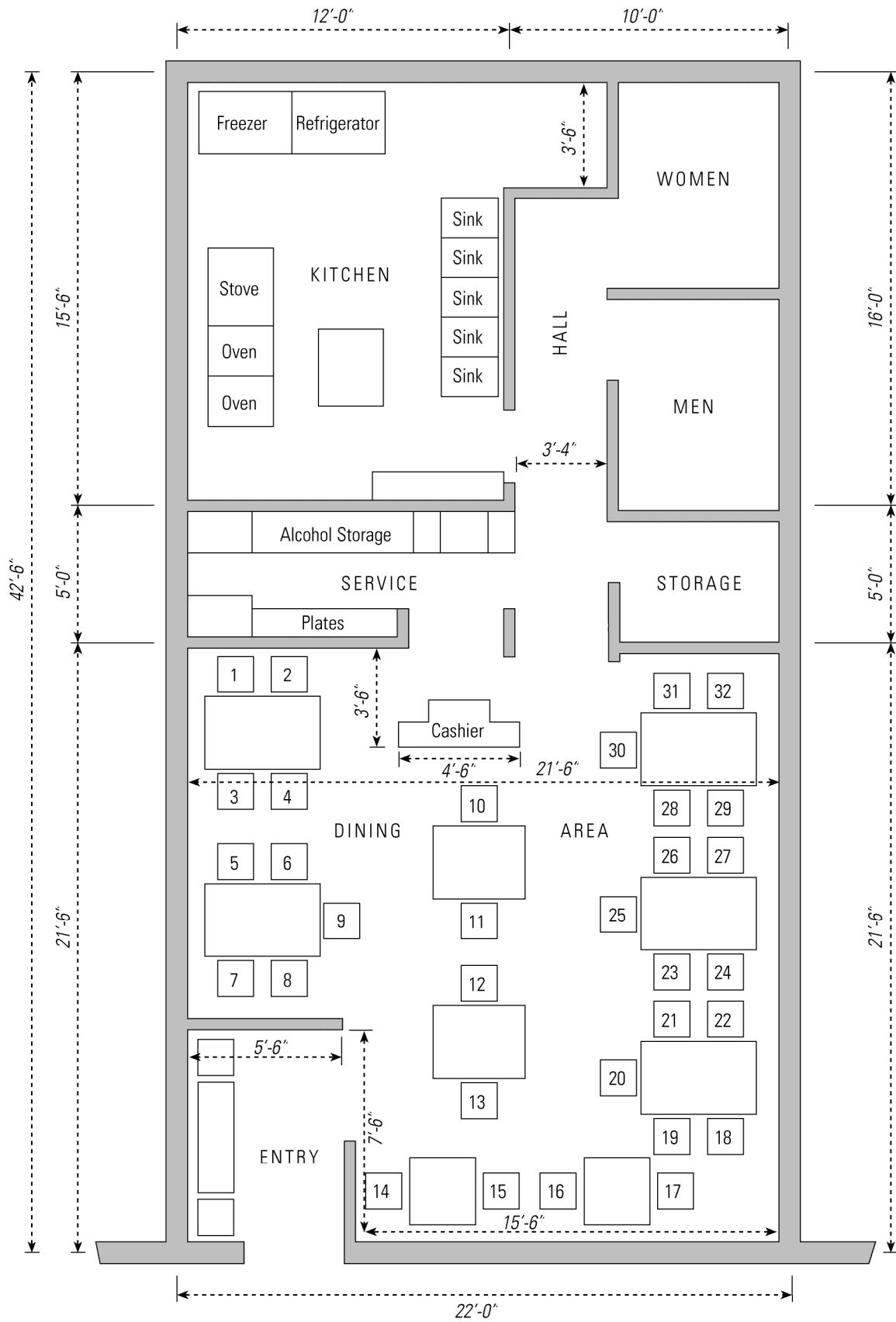

Scale: 3/16" = 1'0"